

TCP 1 - OVERVIEW / DETOUR MAP

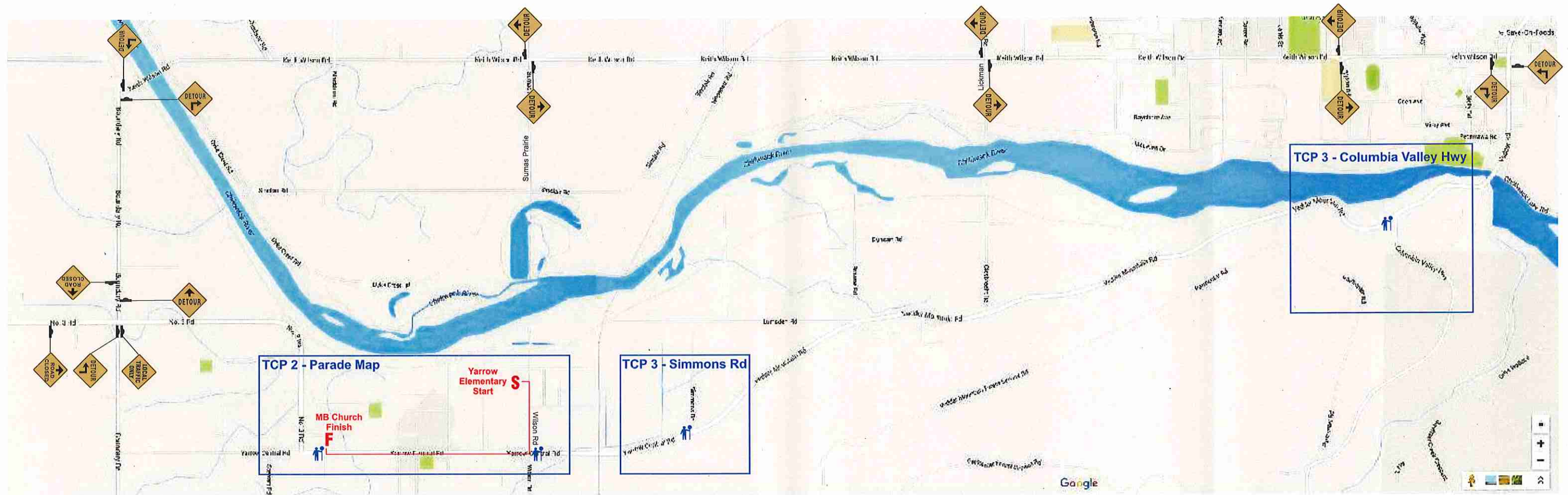

Contractor Name:	TCP #	Date:
City of Chilliwack	TCP 1 of 4	June 3rd, 2017 10am - 11am
Job Description: Yarrow Days Parade		
Traffic Supervisor Contact:	Phone:	Email:
Angelia Fox	604-858-7730	Angelia@StreetwiseTraffic.ca
Traffic Plan Contact:	Phone:	Email:
Tehjay Fox	604-799-6750	Tehjay@StreetwiseTraffic.ca

TRAFFIC CONTROL PLAN
DATE OF LAST REVISION
2017-03-06

LEGEND

- TRAFFIC CONTROL PERSONNEL
- SIGN STAND (TRIPOD)
- SIGN STAND (WINDMASTER)
- SIGN FLAGS
- CLASS 1 BARRICADE
- WORKZONE
- TRAFFIC BARREL
- TUBULAR MARKER - TYPE D
- TRAFFIC CONTROL VEHICLE
- FLASHING ARROW BOARD (FAB)
- EXISTING BUS STOP CLOSED
- RELOCATED BUS STOP

DRAWING SPECIFIC NOTES

- TCP's will assist residents to and from driveways if necessary
- TCP's will assist pedestrians around the workzone

GENERAL NOTES

- All traffic control shall conform to the TCM and the latest catalogue for Standard Traffic Signs
- Signs shown are representations of signs only and the MOTI Construction Sign Catalogue should be used for detailed sign design
- Dimensions shown are in meters and are the minimums except as otherwise indicated
- All permanent signage that will conflict with this site will be covered or removed while the works are in effect
- Active Work Zones and Hazards shall be delineated to protect workers and the travelling public
- Maximum distance between cone/delineator/barrel should be 10m
- Tubular markers and signs will be double based and well secured during windy conditions
- Distances may be adjusted due to urban block length

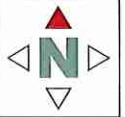

TCP 2 - PARADE MAP



Contractor Name: City of Chilliwack	TCP # TCP 2 of 4	Date: June 3rd, 2017 10am - 11am
Job Description: Yarrow Days Parade		
Traffic Supervisor Contact: Angelia Fox	Phone: 604-858-7730	Email: Angelia@StreetwiseTraffic.ca
Traffic Plan Contact: Tehjay Fox	Phone: 604-799-6750	Email: Tehjay@StreetwiseTraffic.ca

LEGEND	
	TRAFFIC CONTROL PERSONNEL
	SIGN STAND (TRIPOD)
	SIGN STAND (WINDMASTER)
	SIGN FLAGS
	CLASS 1 BARRICADE
	WORKZONE
	PARADE VOLUNTEERS
	TUBULAR MARKER - TYPE D
	TRAFFIC CONTROL VEHICLE
	FLASHING ARROW BOARD (FAB)
	EXISTING BUS STOP CLOSED
	RELOCATED BUS STOP

DRAWING SPECIFIC NOTES

- TCP's will assist residents to and from driveways if necessary
- TCP's will assist pedestrians around the workzone

GENERAL NOTES

- All traffic control shall conform to the TCM and the latest catalogue for Standard Traffic Signs
- Signs shown are representations of signs only and the MOTI Construction Sign Catalogue should be used for detailed sign design
- Dimensions shown are in meters and are the minimums except as otherwise indicated
- All permanent signage that will conflict with this site will be covered or removed while the works are in effect
- Active Work Zones and Hazards shall be delineated to protect workers and the travelling public
- Maximum distance between cone/delineator/barrel should be 10m
- Tubular markers and signs will be double based and well secured during windy conditions
- Distances may be adjusted due to urban block length

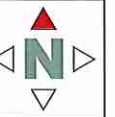

TCP 3 - Simmons Rd



LOCAL TRAFFIC ONLY
Closed at Wilson Rd
9:45am - 11am

TCP 4 - Columbia Valley Hwy

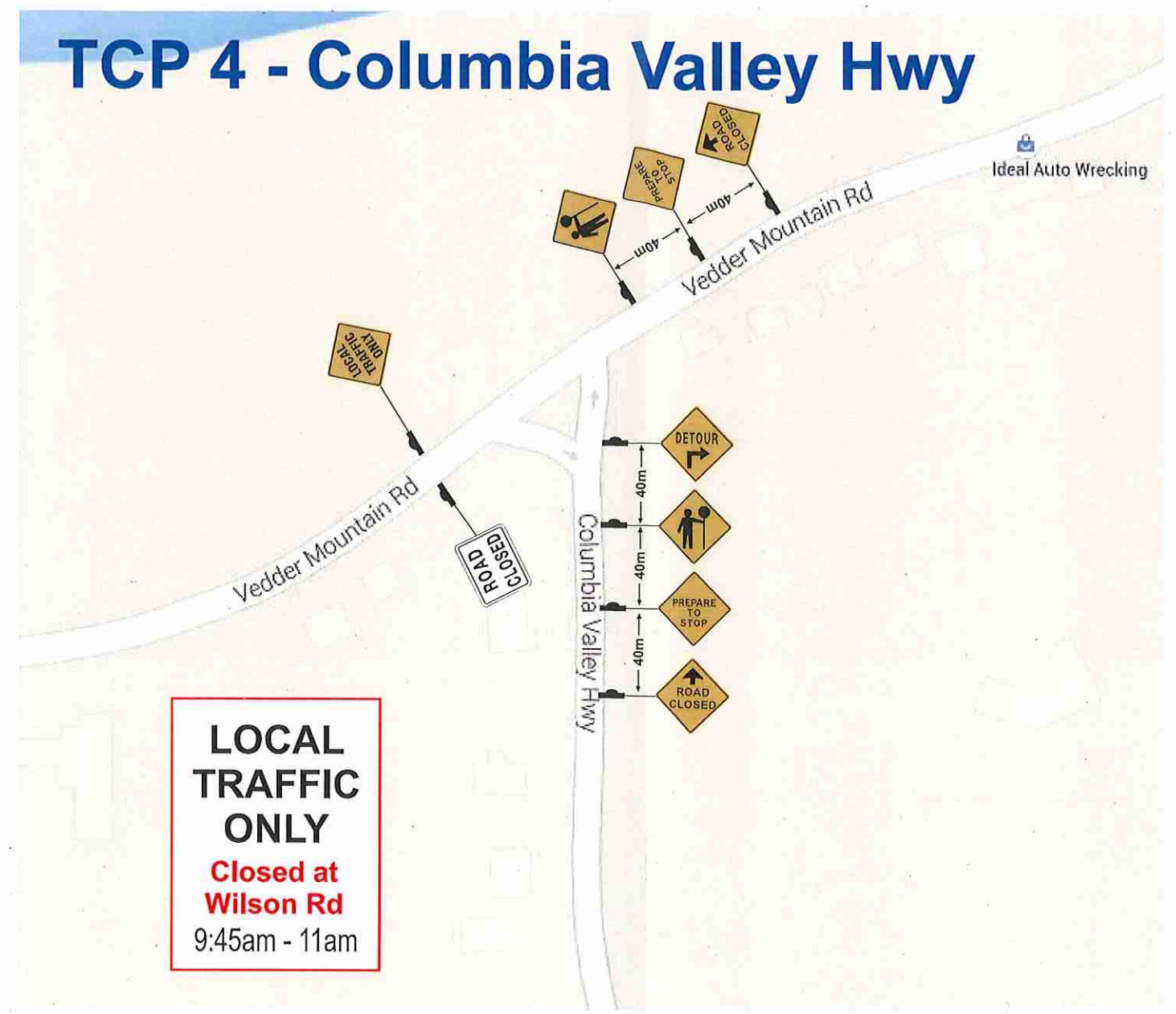

LOCAL TRAFFIC ONLY
Closed at Wilson Rd
9:45am - 11am



Contractor Name:	TCP #	Date:
City of Chilliwack	TCP 3 & 4 of 4	June 3rd, 2017 10am - 11am
Job Description:	Yarrow Days Parade	
Traffic Supervisor Contact:	Phone:	Email:
Angelia Fox	604-858-7730	Angelia@StreetwiseTraffic.ca
Traffic Plan Contact:	Phone:	Email:
Tehjay Fox	604-799-6750	Tehjay@StreetwiseTraffic.ca

TRAFFIC CONTROL PLAN
DATE OF LAST REVISION
2017-03-06

LEGEND	
	TRAFFIC CONTROL PERSONNEL
	SIGN STAND (TRIPOD)
	SIGN STAND (WINDMASTER)
	SIGN FLAGS
	CLASS 1 BARRICADE
	WORKZONE
	TRAFFIC BARREL
	TUBULAR MARKER - TYPE D
	TRAFFIC CONTROL VEHICLE
	FLASHING ARROW BOARD (FAB)
	EXISTING BUS STOP CLOSED
	RELOCATED BUS STOP

DRAWING SPECIFIC NOTES

- TCP's will assist residents to and from driveways if necessary
- TCP's will assist pedestrians around the workzone

GENERAL NOTES

- All traffic control shall conform to the TCM and the latest catalogue for Standard Traffic Signs
- Signs shown are representations of signs only and the MOTI Construction Sign Catalogue should be used for detailed sign design
- Dimensions shown are in meters and are the minimums except as otherwise indicated
- All permanent signage that will conflict with this site will be covered or removed while the works are in effect
- Active Work Zones and Hazards shall be delineated to protect workers and the travelling public
- Maximum distance between cone/delineator/barrel should be 10m
- Tubular markers and signs will be double based and well secured during windy conditions
- Distances may be adjusted due to urban block length